

## REPELLER OVERVIEW

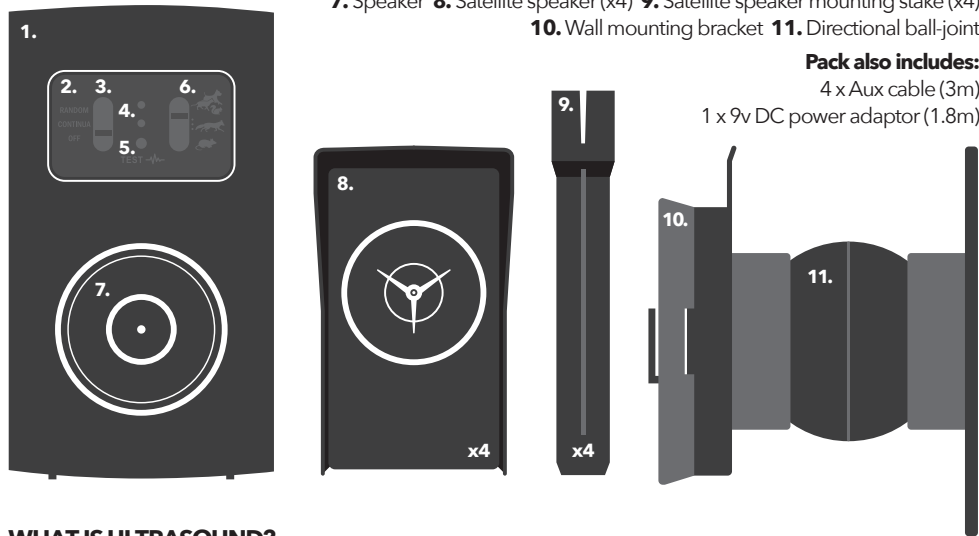

### WHAT IS ULTRASOUND?

Expressed in hertz, ultrasonic sound is sound waves of 20,000 hertz and above, or 20kHz (kilohertz). The high frequency sound emitted by the Mega-Sonic Multi-Speaker 360° Ultrasonic ALL-PEST Repeller is reflected by solid objects such as walls and doors, but will not penetrate them to fill the rooms adjacent. Rooms and buildings with hard surfaces (kitchens, conservatories, sheds and greenhouses) are ideal environments in which to use the repeller. They can also be used in rooms with soft furnishings, such as bedrooms and living rooms, but take care not to obstruct the area in front of the unit. Unwanted pests will find the continuous high frequency sound distressing and will move to a less hostile environment.

### HOW DO I KNOW IF THE REPELLER IS WORKING?

Simply press in the test button and the unit will drop its output frequency to a range that is audible.

### WHAT AREA WILL THE UNIT PROTECT?

The Multi-Speaker 360° Ultrasonic ALL-PEST Repeller is sufficiently powerful to create an exclusion zone of up to 380m<sup>2</sup>.

### HOW LONG DOES IT TAKE TO WORK?

Where established habitats or food sources exist, allow up to 28 days for a full deterrent effect. REMEMBER, good hygiene, food storage and the blocking of entry-points will also help to prevent unwanted pests in home and garden areas.

#### Customer Service:

Tel: +44 (0)1953 881580

Email: info@stvpestcontrol.com

www.stvpestcontrol.com

STV International Ltd, IP25 6ND

© STV International Ltd 2019. All rights reserved.



230 - 240V ~ 50Hz 3W



# MEGA-SONIC<sup>®</sup>

PERFORMANCE TESTED

## Multi-Speaker 360° Ultrasonic ALL-PEST Repeller



### INSTRUCTIONS FOR USE STV748

**Thank you for purchasing the Mega-Sonic Multi-Speaker 360° Ultrasonic ALL-PEST Repeller from The Big Cheese.** This instruction leaflet is designed to provide you with directions on the simple and safe operation of the unit. If, after reading it, you find you still have concerns or queries please do not hesitate to contact us at the Customer Service number or email address provided on the reverse.

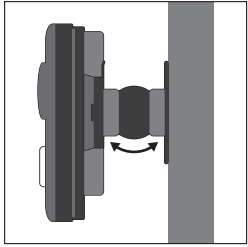

## DIRECTIONS FOR USE

### SINGLE UNIT OPERATION:

- Attach the main unit to a wall, post or fence using the mounting bracket (supplied), adjusting the ball-joint to position the speaker in an appropriate direction or hook the main unit onto a screw in an area where there is, or has been, evidence of unwanted pest activity and within reach of a standard wall socket or power supply (230 - 240V ~ 50Hz 3W).
- Ensure the unit is not obstructed by furniture, buildings, walls or other solid objects as this will limit the coverage. **Ultrasound does not travel through solid objects.**
- Remove all sources of food and any attractant-based pest control methods from the area.
- Select the **OPERATING MODE**.
- Choose the **TARGET PEST FREQUENCY**.
- Switch on power supply.
- Check the unit is operational by pressing the drop-frequency test button on the front of the unit.
- The red LED lights on the unit will light up to indicate that it is working properly.

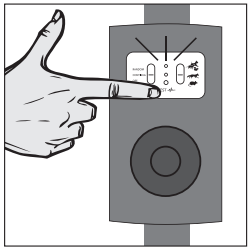
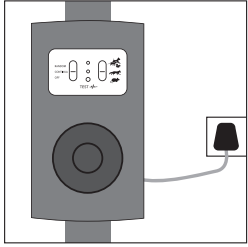

### MULTI-SPEAKER OPERATION:

- For irregular shaped rooms, larger areas or around the edge of buildings, connect and position either **TWO** or **FOUR** satellite speakers (included) as shown on the side of pack prior to switching on the main unit. The satellite speakers must be evenly distributed either side of the main unit.
- REMEMBER: Good hygiene, food storage and the blocking of entry points will also help to prevent re-infestation of unwanted pests.

**CAUTION: Not to be used around rodent pets such as gerbils, hamsters and guinea pigs.**

### TARGET PEST FREQUENCIES



DOG, CAT, SQUIRREL

FOX

MOUSE, RAT

### OPERATING MODES

**RANDOM:** Speaker(s) produce sound waves at varied intervals.

**CONSTANT:** Speaker(s) continuously produce sound waves.

**OFF:** Power off.

### MOUNTING THE UNIT

- To attach the wall mounting bracket to the main unit simply slot the attachment into the positional holes (1) located on the rear of the unit and slide into place. Reverse to remove.
- Or, use the screw hole (2) to mount the main unit directly onto a wall, post or fence.

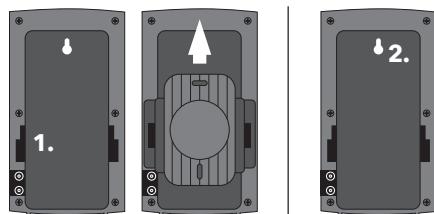

### 360° EXCLUSION ZONE

For irregular shaped spaces, gardens and patio areas

- Position all units 1m away from the centre point of the area you wish to protect and within reach of a power supply
- Connect satellite speakers evenly either side of the main unit
- Face speakers away from the centre point to create an exclusion zone of up to 380m<sup>2</sup>
- Do not obstruct the path of each speaker with a solid object

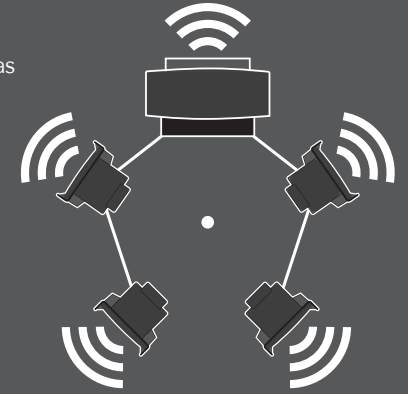

### IN-LINE PERIMETER

For around buildings and along fences, connect the satellite speakers evenly either side of the main unit to maintain maximum output.

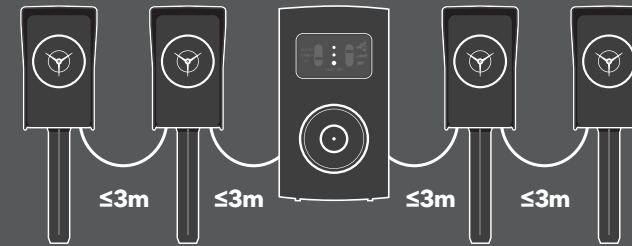

### REMEMBER

Ultrasonic waves behave in a similar way to light waves: they will not travel through solid doors, walls and furniture, nor will they penetrate into nesting sites beneath flooring or within ceiling and wall cavities.

### TIPS TO MAXIMISE PERFORMANCE

- Leave the unit operating continuously.
- Make sure food is stored in containers out of reach of unwanted pests.
- Avoid placing the unit behind furniture or curtains.
- Find and repair any openings where unwanted pests can get in.

### IMPORTANT

- Do not submerge the unit in water.
- Do not cover the unit in a way that prevents proper ventilation, for example by positioning it within cupboards or cabinets, or placing behind curtains.
- Position the unit away from direct heat sources such as radiators, cookers and other appliances (refrigerators) that produce heat.